

**EasyFitFlush** ✓



From  
**The Builders**  
Choice

# EasyFit Flush windows: Slim, Stylish & Strong

The EasyFit Flush window system has been uniquely designed and expertly engineered to offer homeowners the perfect combination of slimline frames with the highest levels of performance.

The timeless style of EasyFit Flush windows complements both contemporary and traditional properties.

With a thermal break and sightlines of just 65mm, EasyFit Flush benefits from industry-leading thermal insulation, offering excellent performance in energy efficiency and acoustic tests.

The modern aesthetic of these profiles has been tailored for residential and commercial properties, for both new build and renovation projects.

The EasyFit Flush system has been designed with ease of installation in mind.

## Colour options



Black

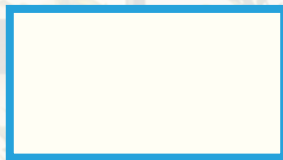

Traffic White



Anthracite Grey

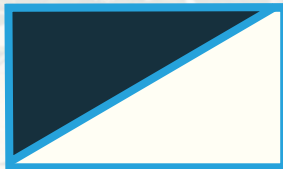

Anthracite Grey /  
Traffic White

We also offer a range of textured finishes including 'Coatex' Anthracite Grey RAL7016, Space Grey RAL9008 and Jet Black RAL 9005, for a premium level of aesthetic quality.

Any RAL colour, including premium textured finishes, available on special order.



U-Values as low  
as 1.0W/m<sup>2</sup>K



Wind resistance:  
CE 2400

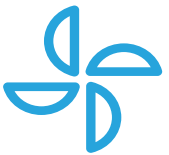

Air permeability:  
CLASS 4 (max)



## Wood effect paint\*

For a traditional finish on our EasyFit Flush windows, try our classic wood effect paint options.

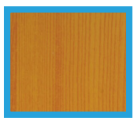

PI303L



PI302TX



RO303L



RO302TX



CE303L



**Opening options:**  
Open out – side hung and top hung

**Noise protection up to 45dB acoustic reduction**

**Water tightness: CLASS E1200**

### Maximum dimensions and weights

Slim Sash	Side Hung	Top Hung
Width	700mm	1200mm
Height	1300mm	1300mm
Min Weight	35kg	50kg
Max Weight	42kg	100kg

  

Heavy Duty Sash	Side Hung	Top Hung
Width	750mm	1800mm
Height	1750mm	1800mm

### Frame

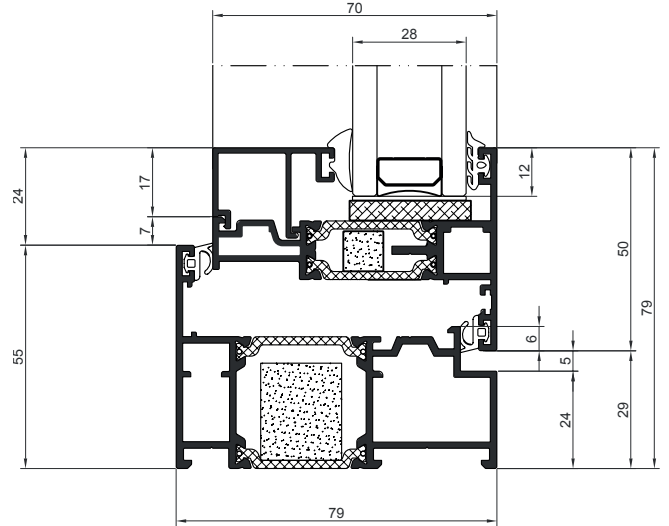

### Mullion

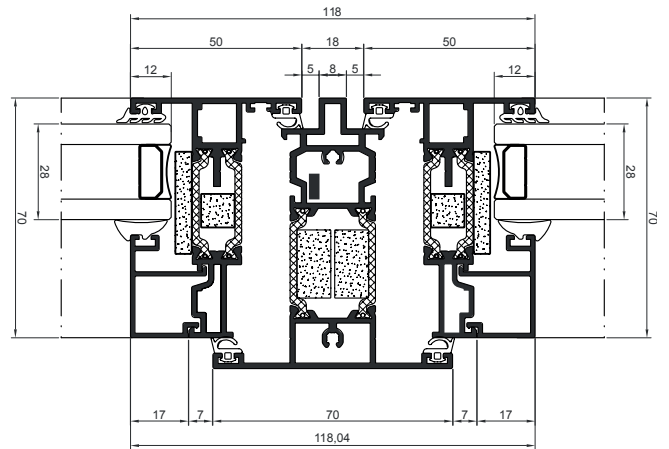

### Maximum Glazing:

44mm

### Sections:

Frame 79mm

Sash 70mm

Window profile thickness: 1.6mm

### Categories achieved at test centre:

Air permeability: BS EN 12207:2000 Class 4

Water tightness: BS EN 12208:2000 Class E1200

Wind resistance: BS EN 12210:2000 Class CE 2400

Reference test 1.438 x 1.355m, 1 sash + 1 fixed.

PAS 24:2016

Reference test 1.438 x 1.330m, 1 sash + 1 fixed.

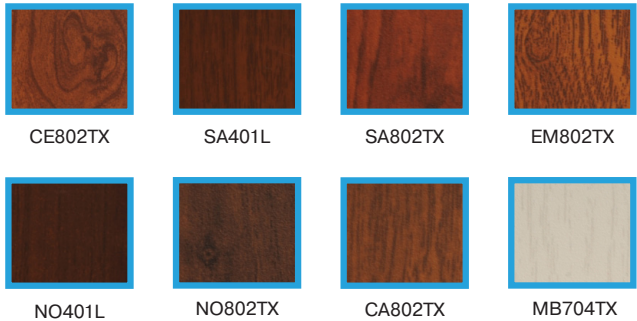

\*Minimum quantities apply



- ✓ **Great range of design options**
- ✓ **Ultra slim frame**
- ✓ **Double and triple-glazed options**
- ✓ **Strong and durable**
- ✓ **Unique thermal insulation profiles**

**Contact us to find out more about EasyFit Flush windows**

0113 271 2122

sales@thebuilderschoice.co.uk

24A Climax Works, Garnet Road, Leeds, LS11 5JY



[www.thebuilderschoice.co.uk](http://www.thebuilderschoice.co.uk)